

## **Addendum to H-58-11-ASAM-03**

### **ENERGY ATTENUATING SEAT WIRE ALIGNMENT**

If repositioning the roller assemblies (PN 157-13000-05) is necessary, proceed as follows:

1. Gain access to the aft side of the seat bulkhead and remove seatback armor.
2. Remove roller assemblies (39), View E on Page 10, and doublers (4, 5, 7, 8, 9, 10) as required, View B on Page 7.
3. Using the removed doublers as a template, fabricate new doublers IAW the instructions provided in View B on Page 7. Match drill all holes in the new doublers EXCEPT roller bracket assembly holes. (4) Temporarily install doublers using cleco fasteners.
4. Install center roller (38) in each of the roller housing assemblies (39) with bolt (40), two washers (41), washer (42), and nut (43) per roller, View E on Page 10.
5. Hold attenuating wires (18) and (25) in position on center rollers (38) and install top and bottom rollers (38) with bolt (40), two washers (41), washer (42), and nut (43) per roller, View E on Page 10.
6. Using a 0.250-inch diameter bit, match drill holes (four each) to holes in roller housing assemblies (39), View D on Page 9.
7. Remove nuts (43), washers (42), washers (41), and bolts (40) and rollers (38) from roller housing assemblies (39), View E on Page 10.
8. Remove doublers (4, 5, 7, 8, 9, 10) as required, View B on Page 7, to clean and deburr all holes.

**WARNING: Epoxy primer coating is flammable. It contains lead and may cause irritation of nose, throat, eyes, skin, respiratory system, and nervous system. Overexposure may result in headache, narcotic effect, nervousness, drying of skin, and possible death. Thoroughly wash skin area with soap and water and immediately flush eyes with water for 15 minutes. If ingested, do not induce vomiting. In all cases get immediate medical attention. When working with epoxy primer coating wear approved respirator, chemical splash goggles, solvent resistant gloves, apron, protective clothing, and barrier cream. Work in a well-ventilated area.**

9. Treat all fabricated aluminum parts for corrosion prevention IAW TM 1-1500-344-23 (MIL-C-81706).
9. Apply primer coating (8010-01-415-2520) to metal surfaces.

**NOTE: Install all rivets wet with Primer.**

10. Install doublers (4) and (5) on bulkhead (2) with six rivets (45) (three per each doubler), View B on Page 7, as required.

## **Addendum to H-58-11-ASAM-##**

### **ENERGY ATTENUATING SEAT WIRE ALIGNMENT**

11. Install doubler (7) on bulkhead (2) with three bolts (46), six washers (47), and three nuts (48), View B on Page 7, as required.
12. Install doubler (8) on bulkhead (2) with 3 bolts (46), 2 bolts (49), 10 washers (47), and 5 nuts (48), View B on Page 7, as required.
13. Install doubler (9) on bulkhead (2) with three bolts (46), six washers (47), and three nuts (48), View B on Page 7, as required.
14. Install doubler (10) on bulkhead (2) with three bolts (46), six washers (47), and three nuts (48), View B on Page 7, as required.
15. Install rivet (50) in doubler (4), View B on Page 7, as required.
16. Install rivet (51) in doubler (5), View B on Page 7, as required.
17. Install angles (12) and (13) on frame with two screws (52) and washers (53) per angle (aft holes), View B on Page 7, as required.
18. Install two radius blocks (15) (one each) on angles (12) and (13) and frame with two screws (54) and washers (53) per radius block, View B on Page 7, as required.

**NOTE: Longer bolts (NAS6604-7) are installed in outboard holes.**

19. Install outboard roller housing assembly (39) on pilot side using two bolts (55), two bolts (56), eight washers (57), and four nuts (58), View F on Page 11, as required.
20. Install remaining three roller housing assemblies (39) using four bolts (56), eight washers (57), and four nuts (58) per each assembly, View F on Page 11, as required.

**WARNING: Polyurethane coating is flammable. Keep away from open flame, sparks, heat, and organic material. Exposure can cause skin, eye, nose, throat, and respiratory system irritation. Prolonged exposure may cause headache, allergic sensitivity, narcotic effect, nausea, and vomiting. Ingestion causes lead poisoning. Thoroughly wash skin area with soap and water and immediately flush eyes with water for 15 minutes. If inhaled, move to fresh air. In all cases get immediate medical attention. When working with polyurethane coating, wear approved chemical resistant rubber gloves, goggles, respirator, and protective clothing. Use in a well-ventilated area.**

21. Paint metal surfaces with polyurethane coating (8010-01-441-0162) IAW  
TM 1-1500-345-23.

Addendum to H-58-11-ASAM-03  
**ENERGY ATTENUATING SEAT WIRE ALIGNMENT**

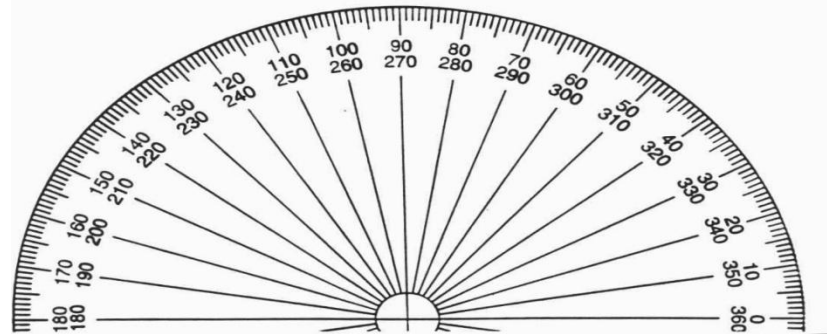
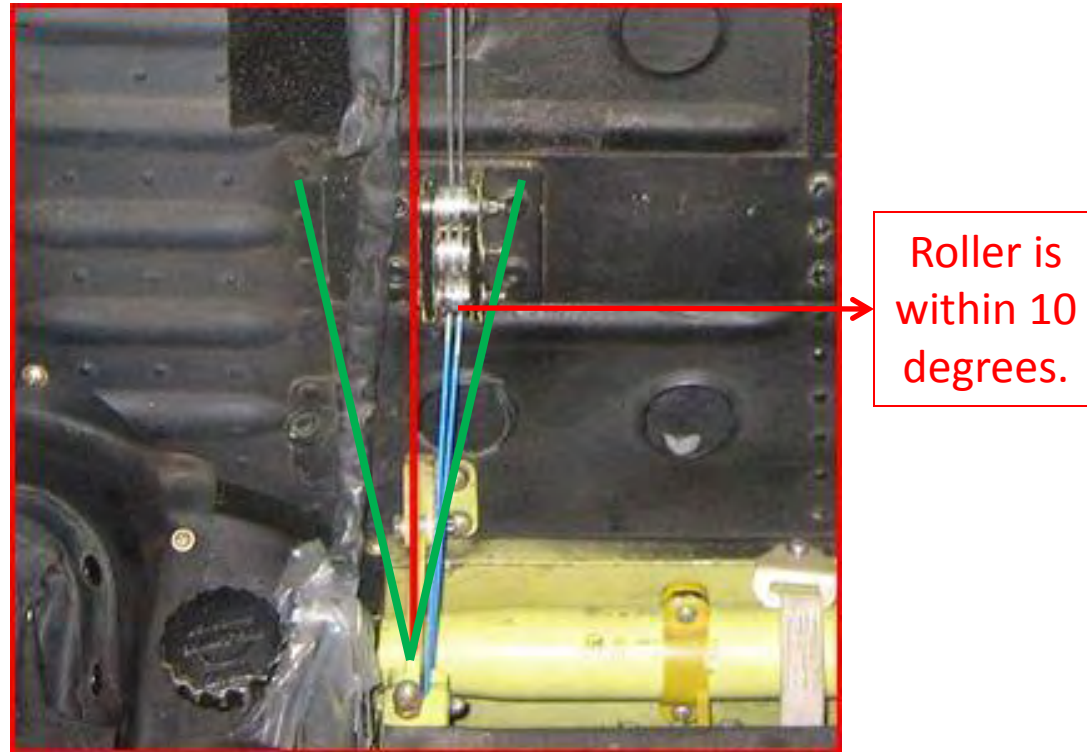

Figure 1

Addendum to H-58-11-ASAM-03  
**ENERGY ATTENUATING SEAT WIRE ALIGNMENT**

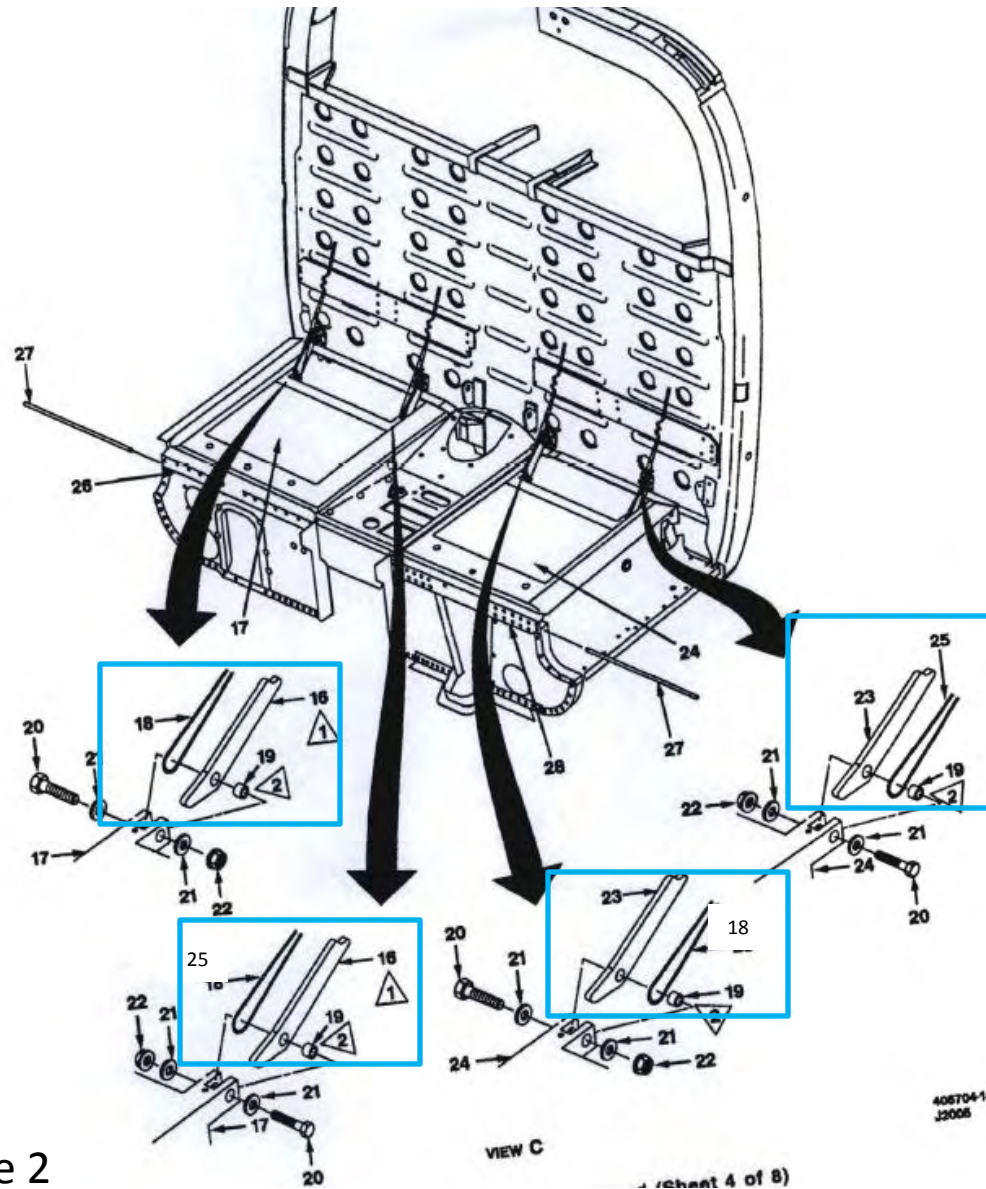

Figure 2

Addendum to H-58-11-ASAM-03  
**ENERGY ATTENUATING SEAT WIRE ALIGNMENT**

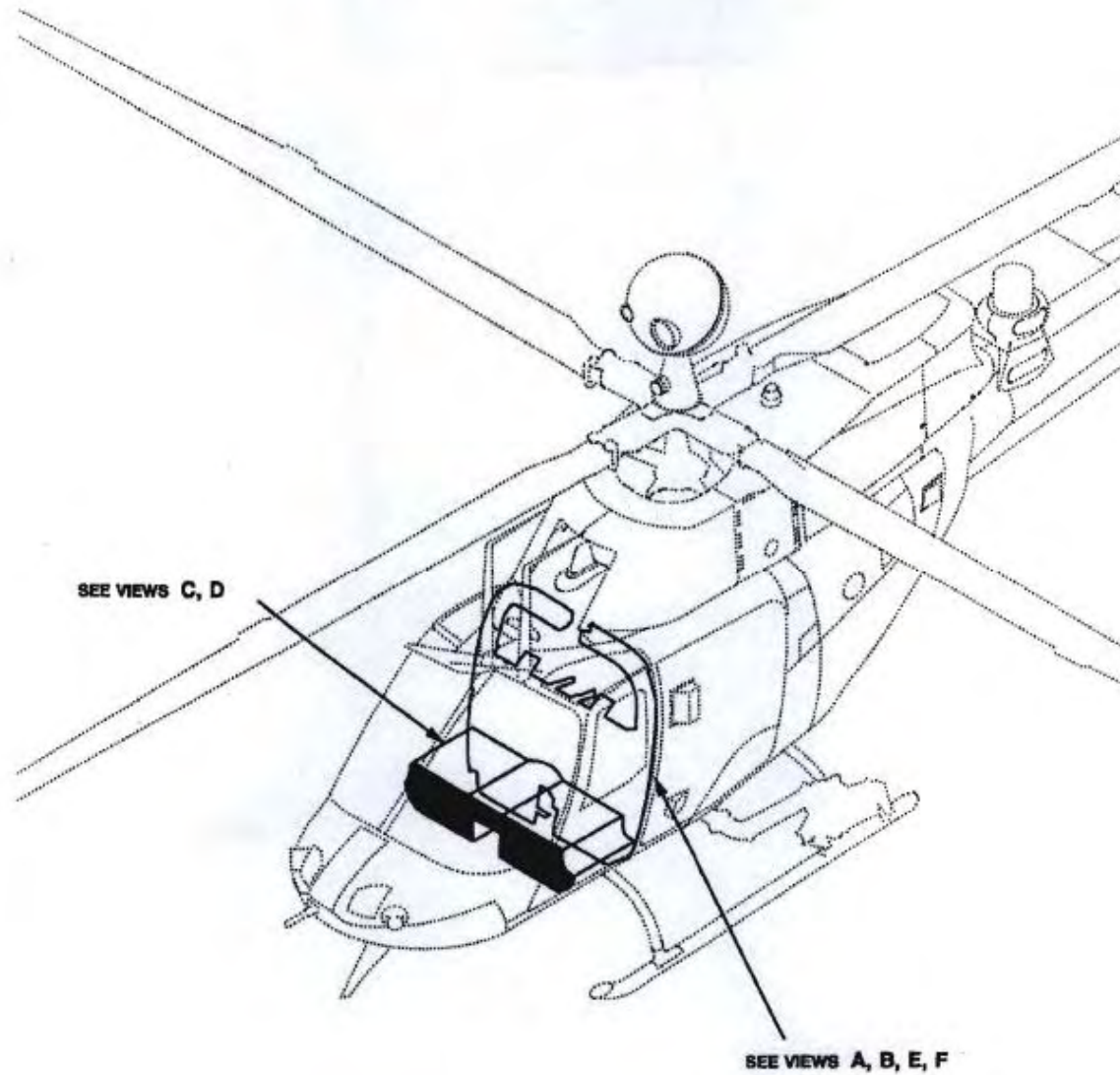

Figure 3

Addendum to H-58-11-ASAM-03  
**ENERGY ATTENUATING SEAT WIRE ALIGNMENT**

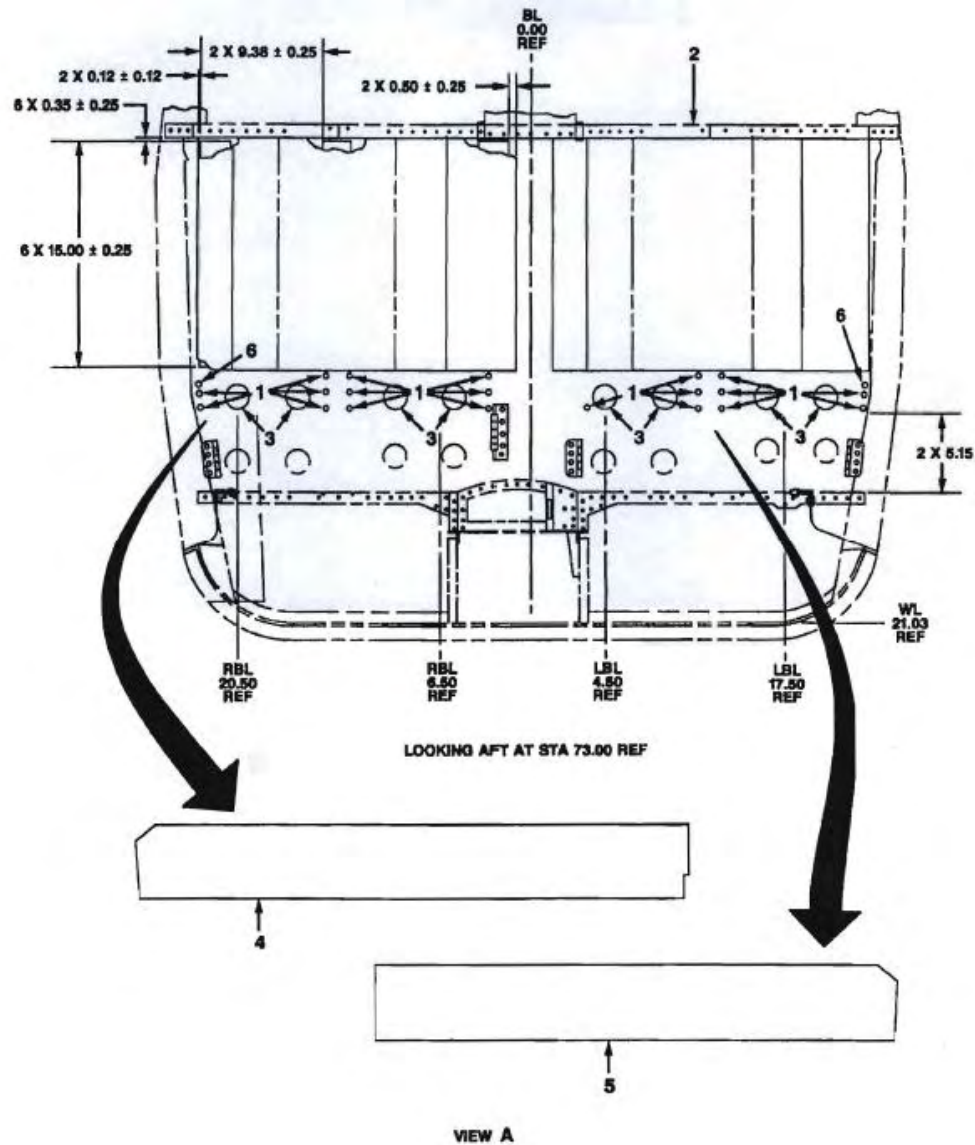

Figure 3



Addendum to H-58-11-ASAM-03

## ENERGY ATTENUATING SEAT WIRE ALIGNMENT

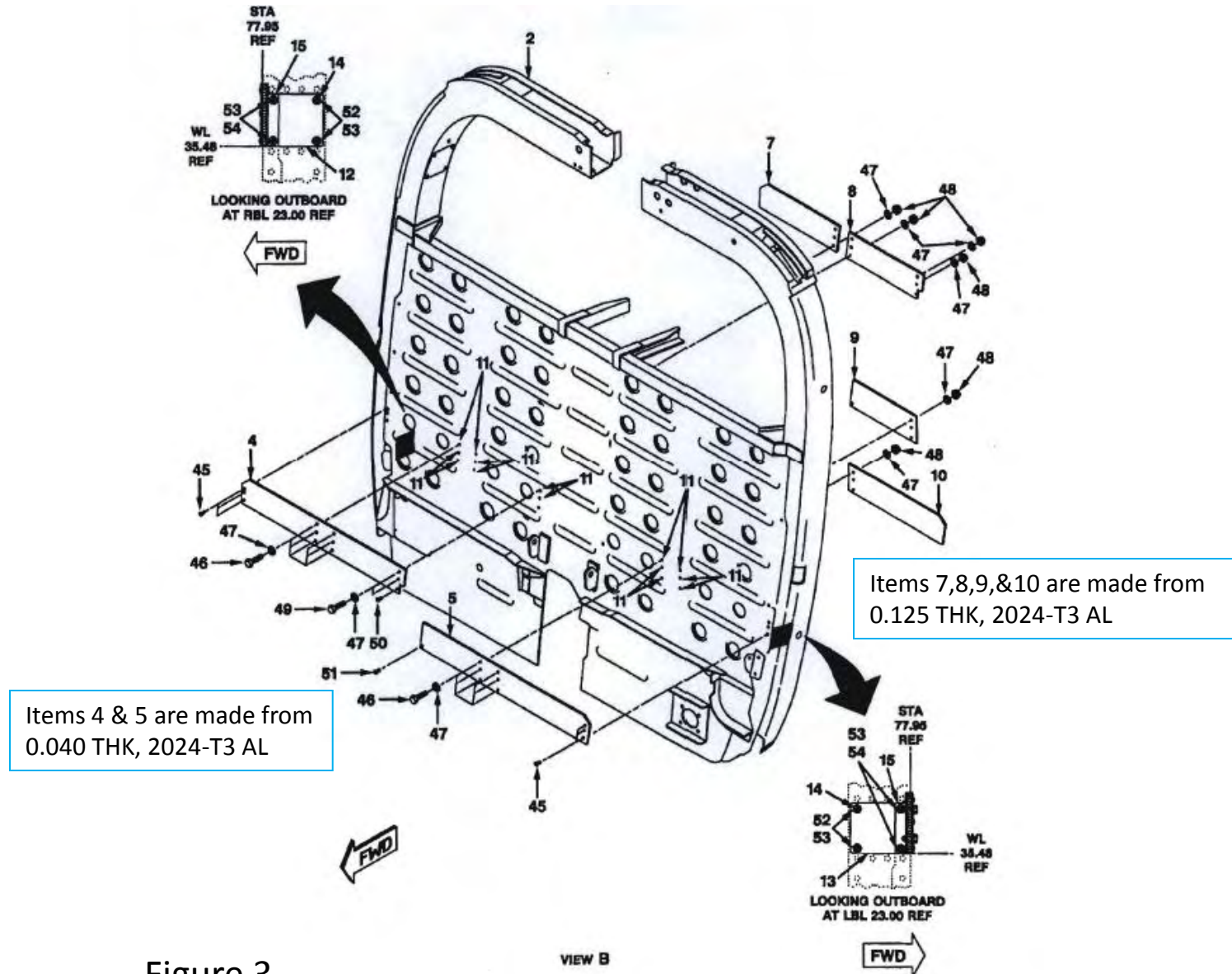

Figure 3

Addendum to H-58-11-ASAM-03  
**ENERGY ATTENUATING SEAT WIRE ALIGNMENT**

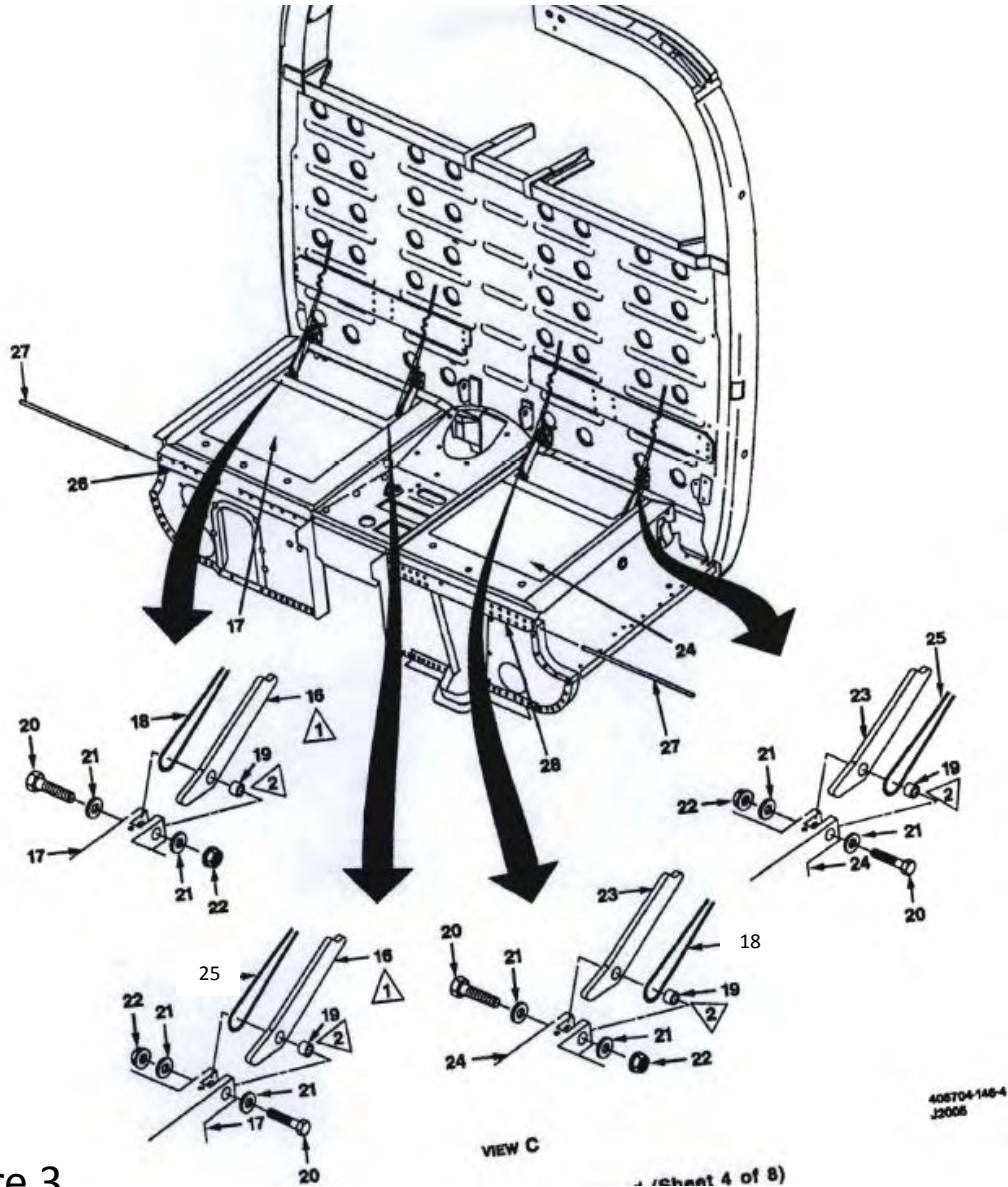

Figure 3



# Addendum to H-58-11-ASAM-03 ENERGY ATTENUATING SEAT WIRE ALIGNMENT

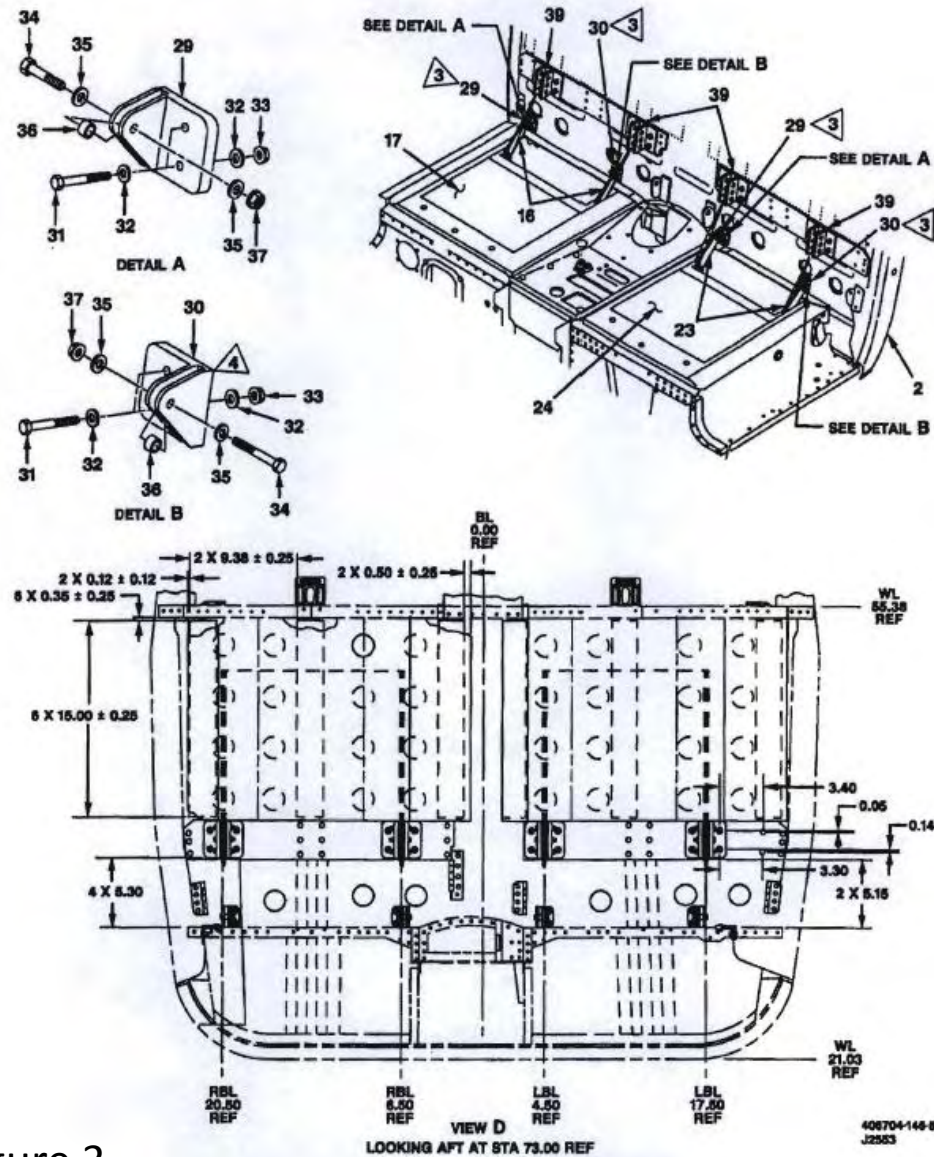

Figure 3

Addendum to H-58-11-ASAM-03  
**ENERGY ATTENUATING SEAT WIRE ALIGNMENT**

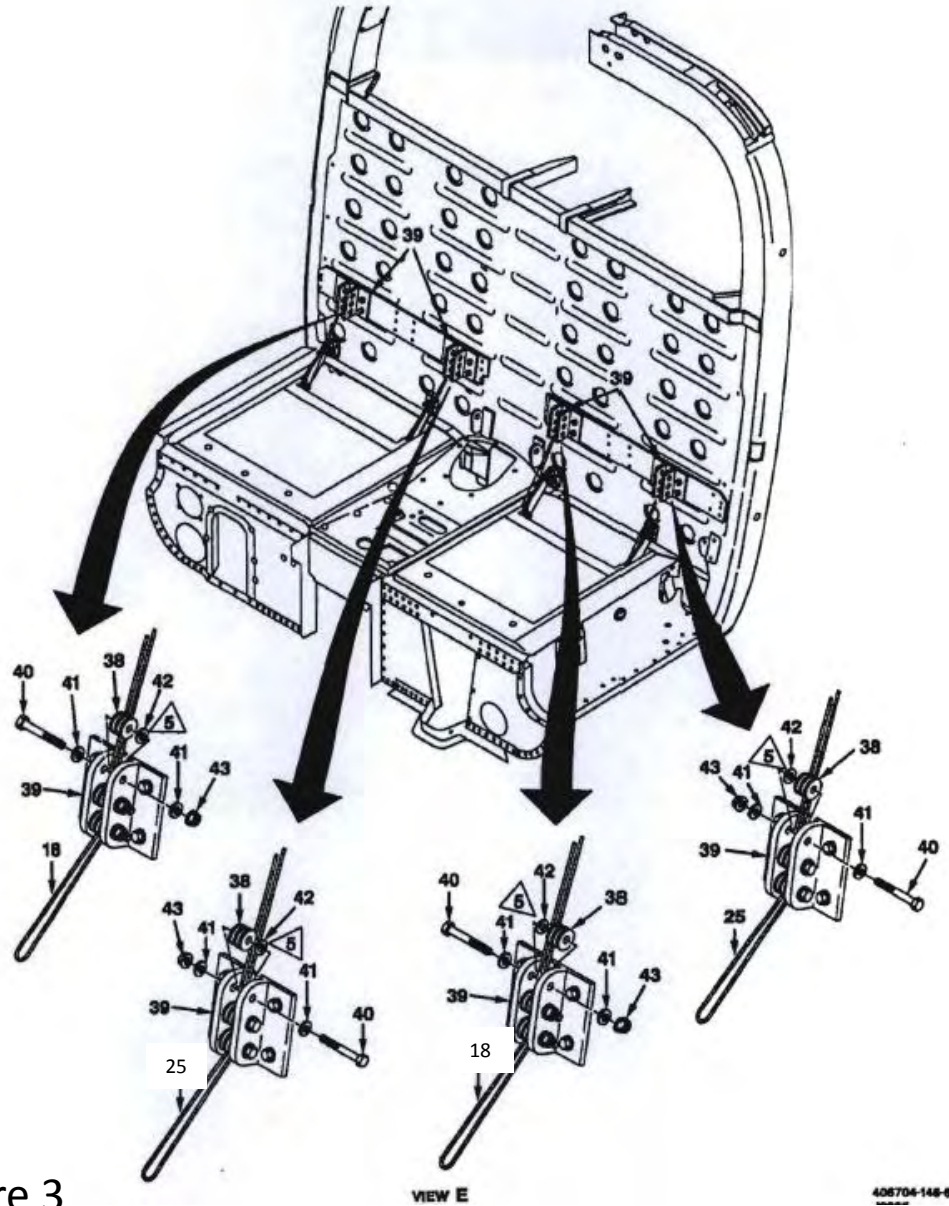
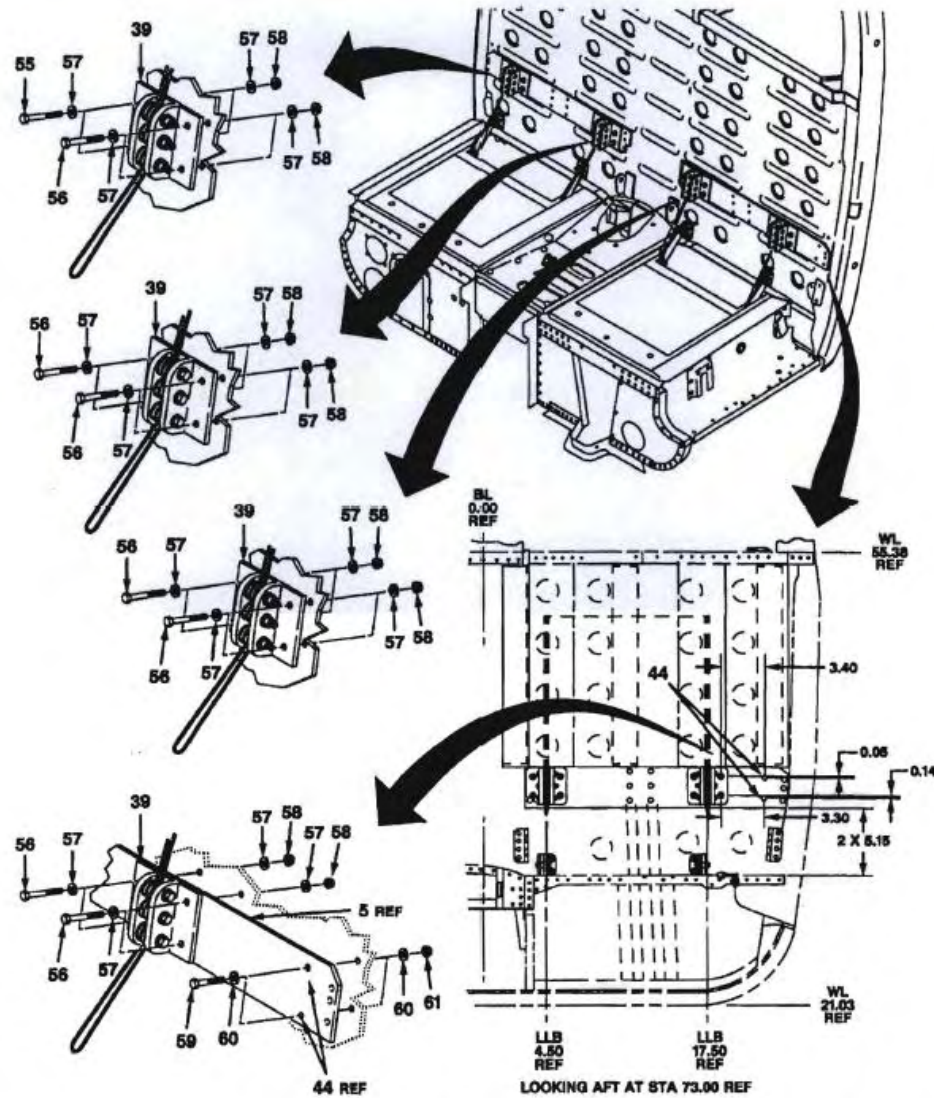

Figure 3

Addendum to H-58-11-ASAM-03  
**ENERGY ATTENUATING SEAT WIRE ALIGNMENT**



VIEW F

406704-148-7  
J2008

Figure 3



# Addendum to H-58-11-ASAM-03

## ENERGY ATTENUATING SEAT WIRE ALIGNMENT

- |  |  |
|--|--|
| <ol style="list-style-type: none"> <li>1. Existing rivets, 20 reqd</li> <li>2. Existing bulkhead</li> <li>3. Existing lightening hole, (8 places)</li> <li>4. Doubler, H57-43000-22</li> <li>5. Doubler, H57-43000-21</li> <li>6. Hole, (2 places)</li> <li>7. Doubler, H57-43000-16</li> <li>8. Doubler, H57-43000-14</li> <li>9. Doubler, H57-43000-17</li> <li>10. Doubler, H57-43000-19</li> <li>11. Hole, (14 places)</li> <li>12. Angle, H57-43000-25</li> <li>13. Angle, H57-43000-26</li> <li>14. Existing nutplate, 8 reqd</li> <li>15. Radius block, H57-43000-35, 2 reqd</li> <li>18. Bracket, 157-13000-64, 2 reqd</li> <li>17. Seat assembly, H57-43000-05</li> <li>18. Attenuating wire, 157-13000-40, 2 reqd</li> <li>19. Spacer, NAS43DD4-56, 4 reqd</li> <li>20. Bolt, NAS6604-14, 4 reqd</li> <li>21. Washer, NAS1149D0416J, 8 reqd</li> <li>22. Nut, MS21042L4, 4 reqd</li> <li>23. Bracket, 157-13000-63, 2 reqd</li> <li>24. Seat assembly, H57-43000-03</li> <li>25. Attenuating wire, 157-13000-39, 2 reqd</li> <li>26. Hinge, 157-13000-75</li> <li>27. Hinge pin, (part of 157-13000-75 and H57-43000-33), 2 reqd</li> <li>28. Hinge, H57-43000-33</li> <li>29. Bracket, 157-13000-08, 2 reqd</li> <li>30. Bracket, 157-13000-07, 2 reqd</li> </ol> | <ol style="list-style-type: none"> <li>31. Screw, MS27039-4-07, 8 reqd</li> <li>32. Washer, NAS1149D0416J, 16 reqd</li> <li>33. Nut, MS21042L4, 8 reqd</li> <li>34. Bolt, NAS6604-8, 4 reqd</li> <li>35. Washer, AN960PD416, 8 reqd</li> <li>36. Spacer, NAS43DD4-16, 4 reqd</li> <li>37. Nut, MS21042L4, 4 reqd</li> <li>38. Roller, 157-13000-37, 12 reqd</li> <li>39. Roller housing assembly, 157-13000-05, 4 reqd</li> <li>40. Bolt, NAS1304-16, 12 reqd</li> <li>41. Washer, AN960PD416, 24 reqd</li> <li>42. Washer, 50Z12-9-2, 12 reqd</li> <li>43. Nut, MS21042L4, 12 reqd</li> <li>44. Hole, (2 places)</li> <li>45. Rivet, CR3242-4-3, 8 reqd</li> <li>46. Bolt, NAS1303-3, 12 reqd</li> <li>47. Washer, NAS1149D0332J, 28 reqd</li> <li>48. Nut, MS21042L3, 14 reqd</li> <li>49. Bolt, NAS1303-4, 2 reqd</li> <li>50. Rivet, CR3213-4-6</li> <li>51. Rivet, CR3242-4-6</li> <li>52. Screw, MS27039-807, 4 reqd</li> <li>53. Washer, NAS1149DN832J, 8 reqd</li> <li>54. Screw, MS27039-809, 4 reqd</li> <li>55. Bolt, NAS6604-7, 2 reqd</li> <li>56. Bolt, NAS6604-8, 14 reqd</li> <li>57. Washer, NAS1149D0463J, 32 reqd</li> <li>58. Nut, MS21042L4, 16 reqd</li> <li>59. Bolt, NAS6604-3, 2 reqd</li> <li>60. Washer, NAS1149D0416J, 4 reqd</li> <li>61. Nut, MS21042L4, 2 reqd</li> </ol> |
|--|--|

### NOTES





-  Trim aft end of 157-13000-64 brackets as required.
-  Ensure spacer NAS43DD4-56 rotates smoothly when installed in bracket 157-13000-63. If spacer does not rotate smoothly, ream hole in bracket.
-  Trim 157-13000-07/-08 bracket assembly as required on outboard installations to clear structure. Shim left side installation as required to engage 157-13000-63 brackets.
-  Alternate screw lengths to accommodate variation in shim thickness for left side installation.
-  Maintain proper location of 50Z12-9-2 washer and related hardware as shown.

Figure 3